

The Virginia Education Wizard has been developed to help students explore careers, find college majors that match their career interests, estimate and compare college costs, find and apply for financial aid and scholarships, plan their transfer from community colleges to four-year institutions, and apply for admission to community colleges. Use the instructions below to create an account and navigate the career section. Use your account to come back to the site anytime to check out the rest of the Wizard.

1. Go to: www.VaWizard.org

2. Select [Create an Account](#) (or [Login](#) using your MyVCCS account credentials if you are an employee or student of a Virginia Community College).



3. Enter a [Username](#) and [Password](#) of your choice. Then enter your [First](#) and [Last Name](#), your [Email Address](#), your [Zip Code](#), and your [Birthday](#).

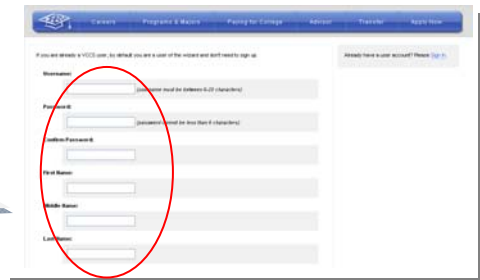

4. Select the [Careers](#) section from the top menu and then select the [Interest Assessment](#).



5. Read the [Instructions](#) for the interest assessment and then select [Start Assessment](#).

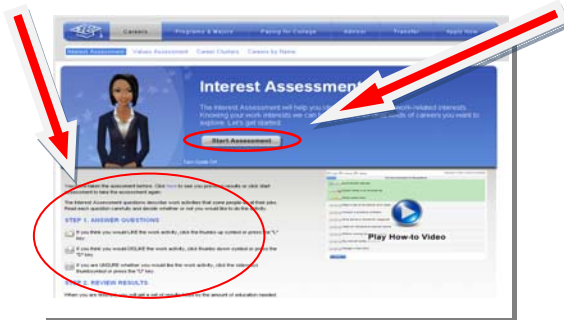

6. Once you have finished the assessment, you will receive an [Interest Type](#). Point your mouse at the interest type to learn what it says about you.

7. Then select on the [Tabs](#) below to view a list of occupations that match your interest type tabbed by the amount of education required. Select [occupations](#) to learn more about them.

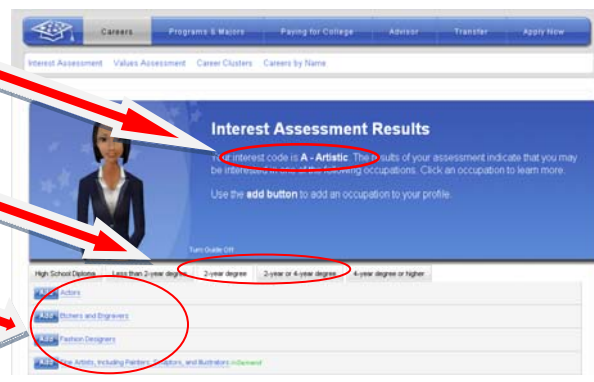

8. Review an Occupation Profile for any occupation that you like. From the Occupation Profile page, you can read a [Brief Description](#) of the occupation, find out [What Kind of Education](#) you need and the [Major](#) at a community college (if the occupation requires education beyond high school), get information on [How Much Money](#) you can expect to make, and much more. To view another career, simply click the [Go to Interest Assessment Results](#) link.

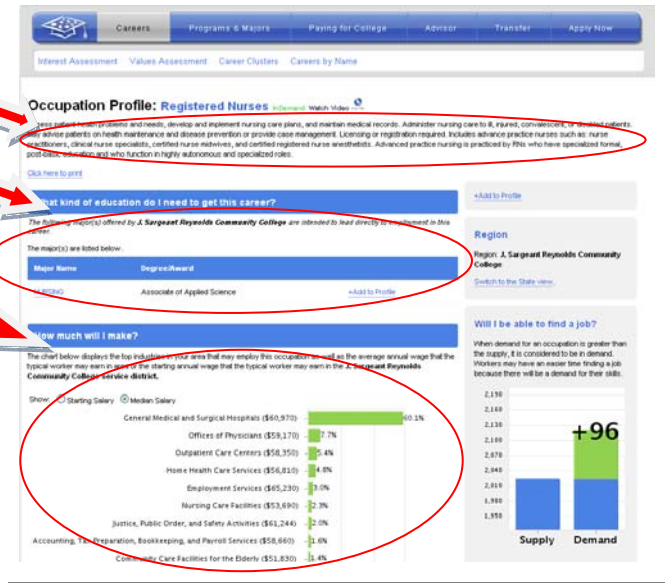
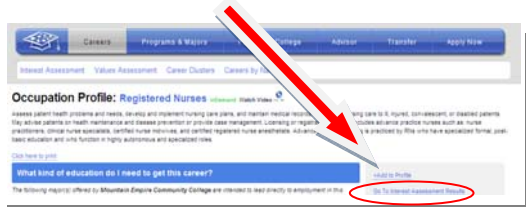

9. Once you have finished reviewing occupations that interest you, select [Values Assessment](#) below the main tool bar.

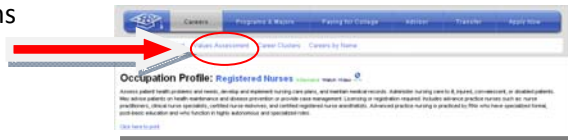

10. Then read the [Instructions](#) and select [Start Assessment](#).

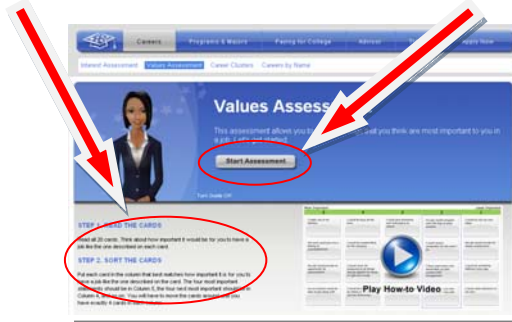

11. Remember, you will have to place all 20 cards. When you are finished, each column should contain 4 cards. Select [Next](#) when you have finished.

12. Once you have finished the assessment, you will receive a [Work Values Type](#). Point your mouse at the values type.

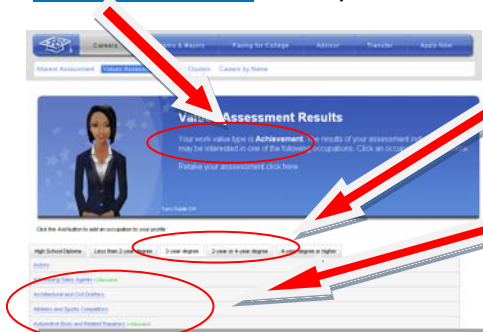
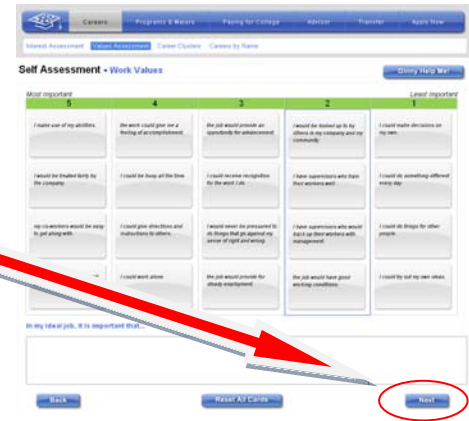

Then select on the [tabs](#) below to view a list of occupations that match your interest type tabbed by the amount of education required. Select [occupations](#) to learn more about them.

13. Now, check out your [Profile](#) by selecting the [Profile](#) link in the top right corner of the webpage. It will contain any programs or careers that you added.

